

Thermometer

Type 760

with weld-in thermowell TW55 type D

E 10.23.01

Ed.23.01

Design	Machine glass thermometer in straight design with weld-in thermowell typ D
Type	760 = case 200x36 mm
Case	Brass coloured aluminium
Temperature element	Blue liquid filling
Location of stem	Radial bottom stem
Spacer	Spacer of steel with screw groove for mounting the case and male thread M18x1,5 for mounting the weld-in thermowell Spacer length 30, 50 or 70 mm
Immersion length	The immersion length of the thermometer together with spacer is adapted for different types of weld-in thermowell TW55 according to D1, D2, D4 och D5
Weld-in thermowell	Weld-in thermowell TW55 type D1, D2, D4 or D5 Material steel or stainless steel Female M18x1,5 for thermometer Certificate 3.1 wetted parts incl. chemical analysis Permanent marking with charge number



Scale range	Error limit	Scale spacing
-30+50°C	2,0%	1°C
0+60°C	1,5%	1°C
0+120°C	2,0%	2°C
0+160°C	4,0%	2°C
0+200°C	4,0%	2°C

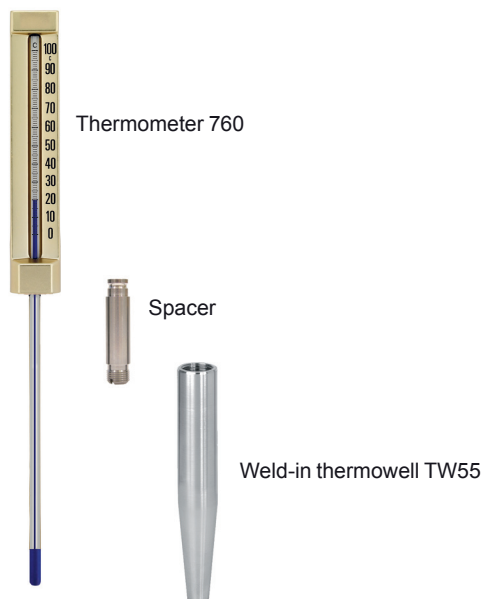

Thermometer

Type 760

with weld-in thermowell TW55 type D

E 10.23.01

Code number for thermometer 760 - Suited for weld-in thermowell TW55 typ D

Range	Immersion thermometer	For spacer	Suited for D 1	Suited for D 2	Suited for D 4	Suited for D 5
0 + 120°C	160 mm	30 mm	07600415	-	-	-
	175 mm	50 mm	07600417	-	-	-
	250 mm	70 mm	-	07600419	07600419	-
	300 mm	70 mm	-	-	-	07600421
0 + 160°C	160 mm	30 mm	07600715	-	-	-
	175 mm	50 mm	07600717	-	-	-
	250 mm	70 mm	-	07600719	07600719	-
0 + 200°C	160 mm	30 mm	07600815	-	-	-
	175 mm	50 mm	07600817	-	-	-
	250 mm	70 mm	-	07600819	07600819	-
	300 mm	70 mm	-	-	-	07600821



Code number for spacer

Type	Material	Length	Code
Spacer	steel	30 mm	75450901
Spacer	stainless steel	50 mm	94900012
Spacer	Steel	70 mm	75450903



Code number

Thermowell TW 55 DIN 43772 form 4

Material certificate 3.1 EN 10204

Wetted parts material with mill certificate incl. chemical analysis

Charge number and material designation



Material - standard	D 1	D 2	D 4	D 5
Carbon steel P250GH (1.0460) (C22.8)	75101901	75101902	75101904	75101905
Stainless steel 1.4571	75102001	75102002	75102004	75102005
Carbon steel 1.7335 (13CrMo4-5)	75102101	75102102	75102104	75102105

Material - special	D 1	D 2	D 4	D 5
Carbon steel 1.5415 (15Mo3/16Mo3)	75102601	75102602	75102604	75102605
Carbon steel 1.7380 (10CrMo910)	75102301	75102302	75102304	75102305
Chromium/Molybdenum alloy steel F91	75102501	75102502	75102504	75102505
Stainless steel Duplex F51 (1.4462)	75102201	75102202	75102204	75102205
Stainless steel 1.4539	75102701	75102702	75102704	75102705
Stainless steel 304/304L (1.4307)	75102901	75102902	75102904	75102905

AB Svenska Industri Instrument SINI

Head office Box 8923, SE-402 73 Göteborg
Bransch office Box 1208, SE-751 42 Uppsala

Visiting address

Exportgatan 38 D
Suttungsgränd 3

Telephone

+46 31 7425600
+46 18 100033

Telefax

+46 31 7425601
+46 18 100044

Internet

www.sini.se
mail: info@sini.se

WIKAL

Part of your business

Thermometer

Type 760

with weld-in thermowell TW55 type D

E 10.23.01

Code number för thermometer 760

with spacer and weld-in thermowell TW55 type D



760 with weld-in thermowell Carbon steel P250GH (1.0460) (C22.8)	D 1	D 1	D 2	D 4	D 5
with spacer	30 mm	50 mm	70 mm	70 mm	70 mm
0 + 120°C	57600410	57600411	57600442	57600444	57600445
0 + 160°C	57600710	57600711	57600742	57600744	-
0 + 200°C	57600810	57600811	57600842	57600844	57600845

760 with weld-in thermowell Stainless steel 1.4571	D 1	D 1	D 2	D 4	D 5
with spacer	30 mm	50 mm	70 mm	70 mm	70 mm
0 + 120°C	57600420	57600421	57600452	57600454	57600455
0 + 160°C	57600720	57600721	57600752	57600754	-
0 + 200°C	57600820	57600821	57600852	57600854	57600855

760 with weld-in thermowell Carbon steel 1.7335 (13CrMo4-5)	D 1	D 1	D 2	D 4	D 5
with spacer	30 mm	50 mm	70 mm	70 mm	70 mm
0 + 120°C	57600430	57600431	57600462	57600464	57600465
0 + 160°C	57600730	57600731	57600762	57600764	-
0 + 200°C	57600830	57600831	57600862	57600864	57600865

Thermometer

Type 760

with weld-in thermowell TW55 type D

E 10.23.01

Case thermometer 760

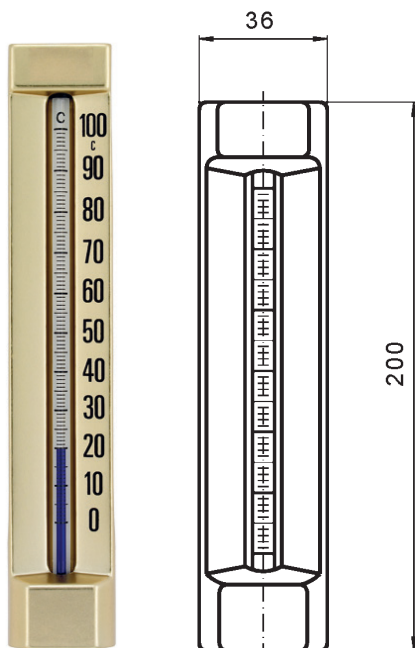

Spacer

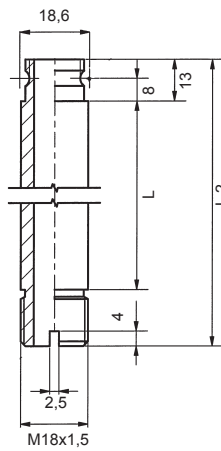

Type	Type	L	L 2
Spacer	1	30	58
Spacer	2	50	78
Spacer	3	70	98

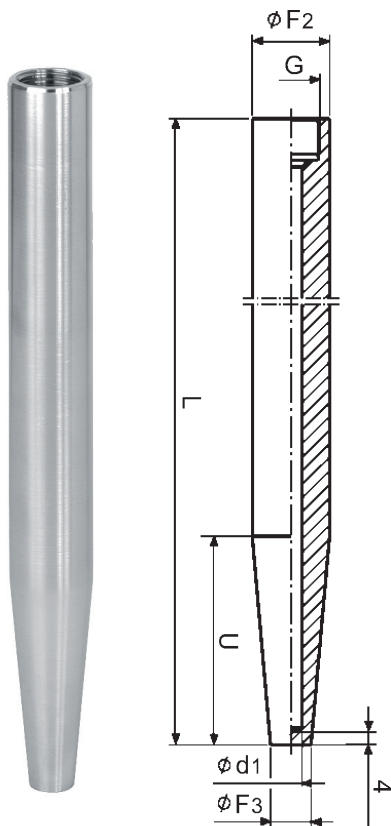

Weld-in thermowell TW55 type D

Type	L	U	F2	F3	N	d1
D 1	140	65	24	12,5	M18x1,5	7
D 2	200	125	24	12,5	M18x1,5	7
D 4	200	65	24	12,5	M18x1,5	7
D 5	260	125	24	12,5	M18x1,5	7

Thermometer

Type 760

with weld-in thermowell TW55 type D

E 10.23.01

Dimensions for thermometer 760

with spacer and weld-in thermowell TW55 type D

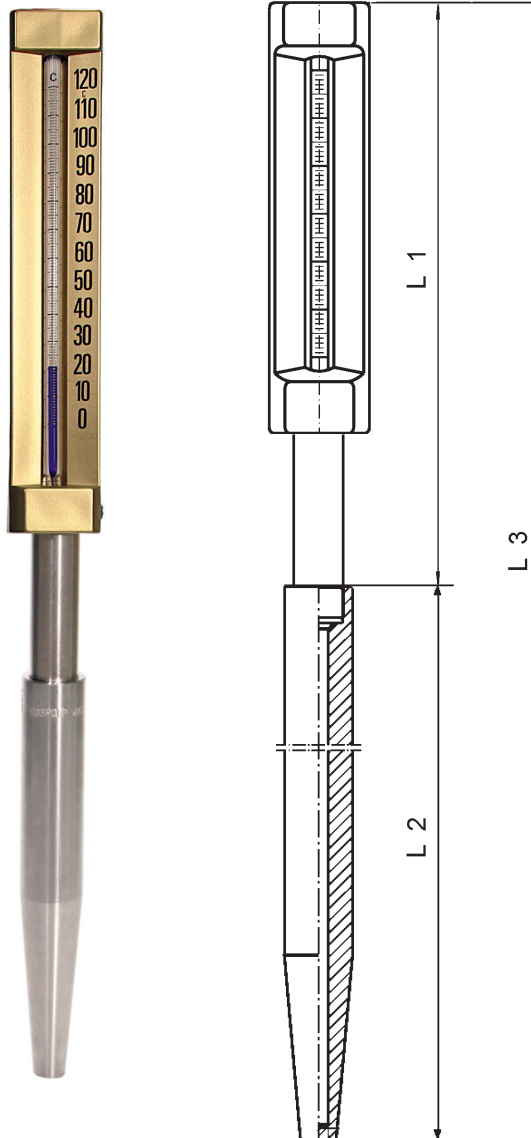

Type	Type	Spacer	L 1	L 2	L 3
760	D 1	30 mm	230	140	370
760	D 1	50 mm	250	140	390
760	D 2	70 mm	270	200	470
760	D 4	70 mm	270	200	470
760	D 5	70 mm	270	260	530

Thermometer

Type 760

with weld-in thermowell TW55 type D

E 10.23.01

Connection piece D-45

Connection piece. Material certificate 3.1 EN 10204

Wetted parts material with mill certificate incl. chemical analysis

Chargenummer och materialbeteckning

Material - standard	Art.nr
Carbon steel P250GH (1.0460) (C22.8)	75401000
Stainless steel 1.4571	75401010
Carbon steel 1.7335 (13CrMo4-5)	75401020

Material - special	Art.nr
Stainless steel 1.4404	75401023
Chromium/Molybdenum alloy steel F91	75401026
Stainless steel Duplex F51 (1.4462)	75401022
Stainless steel Duplex 1.4539	75401024
Carbon Steel A105	75401025
Carbon steel 1.7380 (10CrMo910)	75401031
Carbon steel 1.5415 (15Mo3/16Mo3)	75401028
Stainless steel 304/304L (1.4307)	75401034
Stainless steel 1.4541	75401029
Stainless steel 1.4301	75401032
Hastelloy C-276	75401033

